

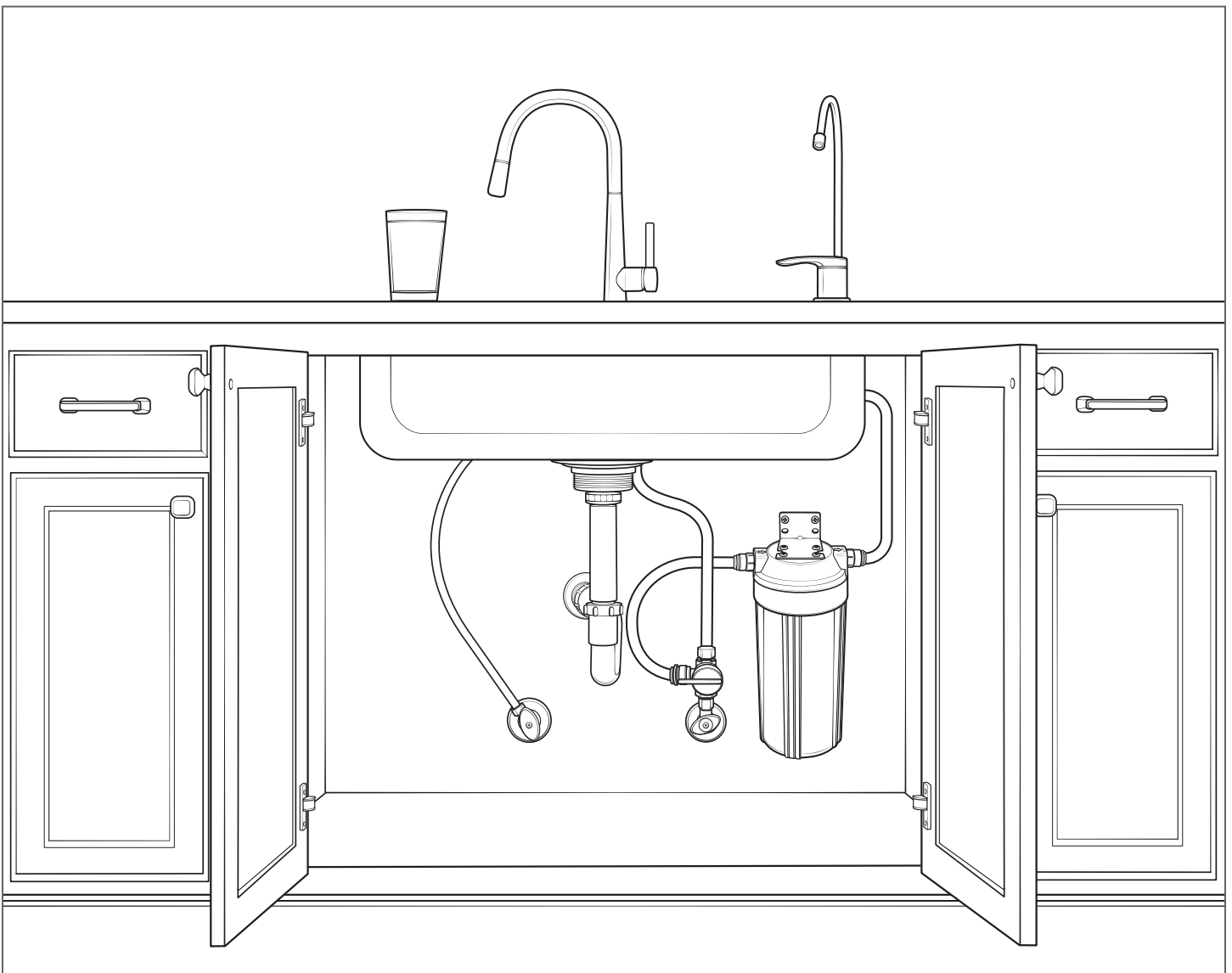

Direct Connect Plus

Water Filtration System



Maintenance

If flow or pressure is reduced through the faucet, this is a sign the ceramic filter needs to be cleaned or replaced. If flow is not restored after cleaning, the filter will need to be replaced. At a minimum, the filter should be replaced every 12 months.

Follow these steps to replace or clean the Filter:

1. Place a towel(s) under the cold-water shut-off valve. Turn off the water supply to the filter system by closing the angle stop valve. Open the cold-water side dedicated faucet to relieve the water pressure.
2. Remove the Housing Sump using the Housing Wrench.
3. Remove the old Filter and gaskets.

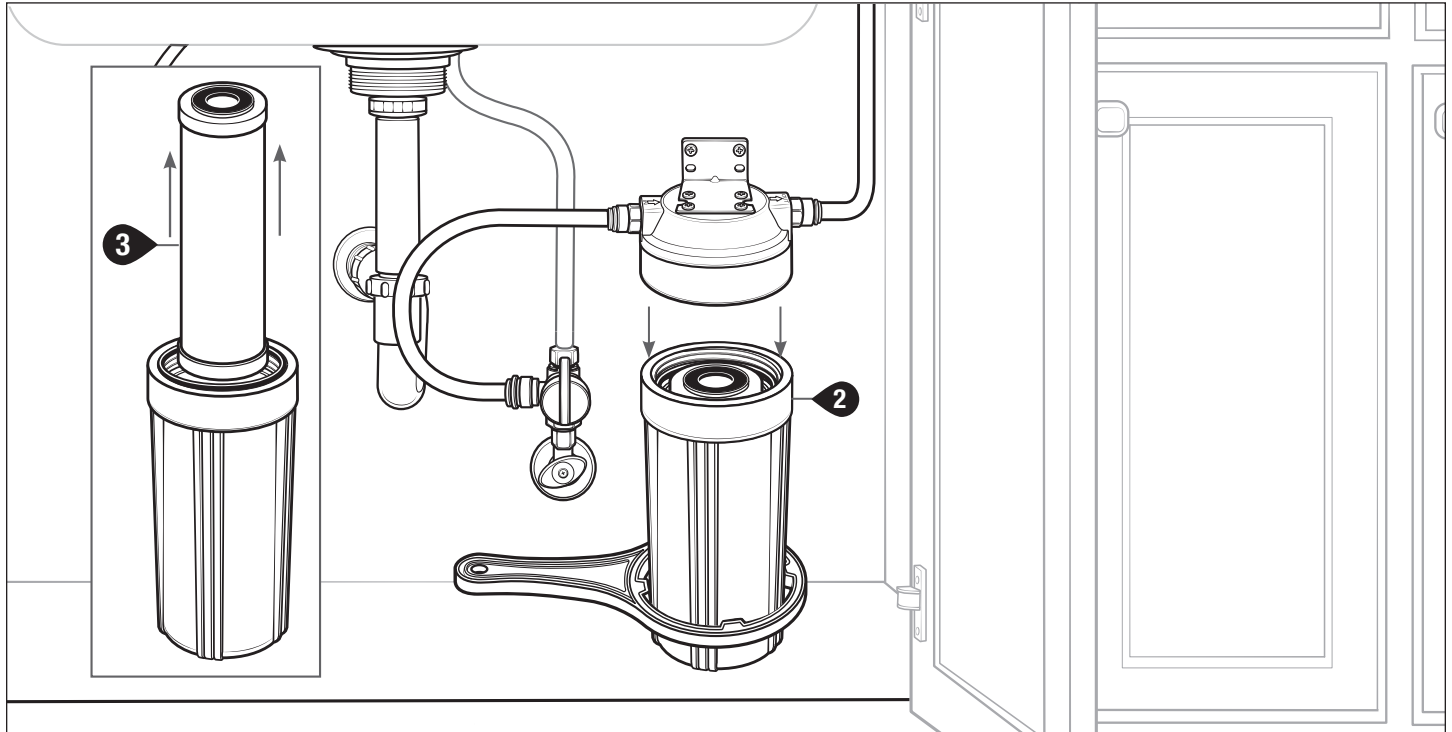

Replacing the Filter

4. Place the new Filter and gaskets in the Housing Sump.
5. Re-attach the Housing Sump to the Housing Cap and hand tighten. Do not over-tighten.
6. Slowly open the angle stop valve checking the Housing Cap and Housing Sump connection for leaks. If there is a leak, using the Housing Wrench, tighten the Housing Sump by rotating it in small increments until firmly secured and no leaks present.

Tip: Over-tightening the Housing Sump will make future removal difficult.

+ " Ô@&A&A^ { aâ a * & } } ^ & c } • A | A a • k @ A & | a E æ | A @ d - A a c ^ E @ A c * | A d] A a c ^ E a a @ & | a E æ | A c ^ E Q ^ a • A c a d } • @ @ A c a a * A | c @ | A d A @ A • @ A a a c * A | A c } A @ A c @ ^ a A a c * E U] ^ A @ A a a c a A c e & A a i } A @ A æ | A a - E @ A c } A - A a A @ A c A • æ | æ A | A A A c Q ^ | E Q • @ @ A a a c a A c e & o | A A A c A a } c • A a | A A ^ E p [c k A } [| c a A A ^ { a | A c e | A A a & a } A A c @ A c A | • @ E Q æ A a A A , A æ • A A & [] | c | A • E

, " Discard the old Filter and gaskets.

Cleaning the Filter

- % Hold the filter under **cold** running water, using a Scotch-Brite scour pad (green or blue) to clean the exterior of the ceramic filter. This will remove accumulated materials to expose a fresh ceramic surface.
- & " Return the Filter and gaskets back the Housing Sump.
- ' " Rinse the Filter after rubbing the entire surface.
- (" Re-attach the Housing Sump to the Housing Cap and hand tighten. Do not over-tighten.
-) " Slowly open the cold-water shut-off valve, checking the Housing Cap and Housing Sump connection for leaks. If there is a leak, using the Housing Wrench, tighten the Housing Sump by rotating it in small increments until firmly secured and no leaks present.

** Ô@&A&A^ { aâ a * & } } ^ & c } • A | A a • k @ A & | a E æ | A @ d - A a c ^ E @ A c * | A d] A a c ^ E a a @ & | a E æ | A c ^ E Q ^ a • A c a d } • @ @ A c a a * A | c @ | A d A @ A • @ A a a c * A | A c } A @ A c @ ^ a A a c * E U] ^ A @ A a a c a A c e & A a } A | A A , A a } c • A a | A A ^ E p [c k A } [| c a A A ^ { a | A c e | A A a & a } A A c @ A c A | • @ E Q æ A a A A , A æ • A A & [] | c | A • E