

SS Gravity Countertop Filter Models 107050/107051

Product Components

- Lid knob with washer and screw
- Upper chamber lid
- Upper chamber
- Filter with sealing washer and wing nut (107050: x2 or 107051: x4)
- Upper chamber base plugs (x3)
- Lower chamber
- Spout
- Stainless steel cover (x2)
- Silicone washer (x2)
- Spout Nut
- Lower chamber non-slip base

Assembly

Important! Wash all stainless steel parts with mild soap and a non-abrasive cloth/pad before assembly.

Upper Chamber Lid

1. Place the Lid Knob over the lid hole. Insert the small screw and washer on the opposite side of the lid. Hand tighten.

Upper Chamber Assembly

Important! Handle the Filters by the plastic base and not the ceramic exterior, especially when installing and securing. Ensure the black sealing washer is on the Filter posts.

2. Insert a Filter into one of the holes in the Upper Chamber.
3. Holding the Filter base, put the Filter post through a hole in the Upper Chamber and secure with a Filter wing nut (x2 or 4).
Note: Insert an Upper Chamber Base Plug in any unused holes.

Lower Chamber Assembly

4. Slide the Stainless Steel Cover onto the Spout followed by the Silicone Washer.
5. Insert the Spout assembly into the Lower Chamber opening.
6. Place the second Silicone Washer and Stainless Steel Cover and onto the threaded end of the Spout.
7. Using the Spout Nut, hand tighten to seal.
8. Turn the spout handle to the closed position.
9. Place the Lower Chamber onto the non-slip base.
10. Place the Upper Chamber onto the Lower Chamber.

Use

Important! These filters do not require priming. It is recommended that 2-3 chambers of water be flushed through the filters before consuming. This is to rid the filters and chambers of any manufacturing residues. Discard this water and clean the Lower Chamber. Your system is now ready for use. **Note:** It is common for carbon particles to be present in the Lower Chamber after the filtering process. This will dissipate as the system is used.

TIP! Do not overfill the Upper Chamber with more water than there is space available in the Lower Chamber. (Example: If the Lower Chamber is half full, add water until the Upper Chamber is half full)

TIP! Remove the Upper Chamber Lid to prevent mildew and mold build-up on the Upper Chamber and Filters when not filtering.

Maintenance

Inspect and/or clean the filters as needed. Follow these steps to clean the Filters:

1. Holding the Filter base, unscrew the Filter wing nut and remove the Filters.
2. Cradle the Filter under **cold** running water using a Scotch-Brite pad. **Important!** Always brush away from the post end.
3. Re-assemble according to the Upper Chamber Assembly instructions.

Monthly: Clean the Upper and Lower Chambers using mild soap and a non-abrasive cloth/pad.

Annually: Replace Filters. **Note:** Water conditions may require more frequent filter changes.

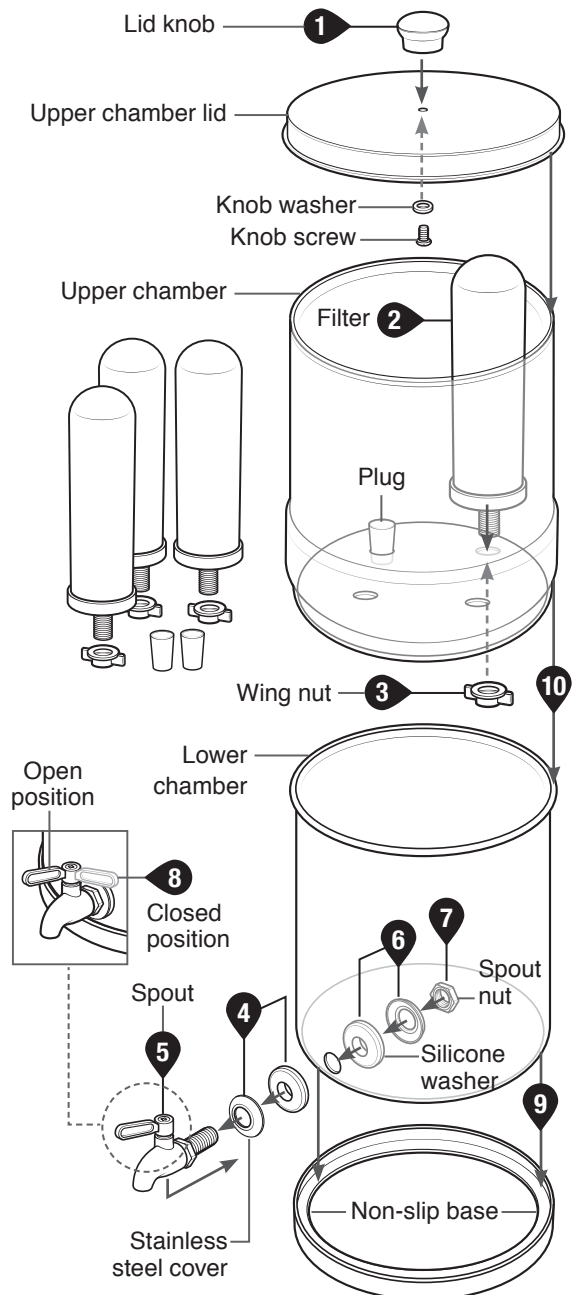

Scan the QR code to see our YouTube video of the Gravity Countertop assembly.

